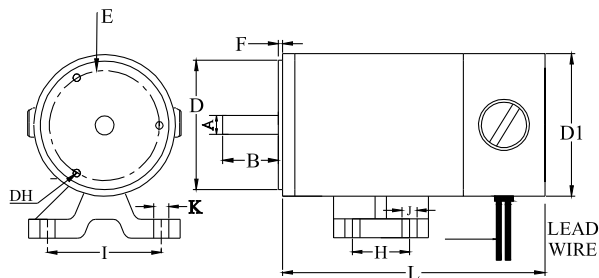

**DYNAFLUX D75 SERIES P. M. DC MOTORS**

MECHANICAL DIMENSIONS FOR MOTORS.

D1	A	B	C	D	S	E	F	DH	G	H	I	J	K	KEYWAY
75	10	30	60	68	75	58	2	M5	37	30	60	8	8	-

SPECIFICATIONS

POWER IN WATTS/HP	SPEED IN RPM	VOLTAGE IN VDC			CURR. IN AMPS			TORQUE IN KG-CM	INSL. CLASS	DUTY CYCLE	PROTEC-TION	L TENV	WEIGHT (KG)
		V1	V2	V3	A1	A2	A3						
40/0.05	1500	180			0.3			2.5	B	S1	IP44	177	3.5
40/0.05	3000	180			0.3			1.3	B	S1	IP44	177	
75/0.10	1500	180	24	12	0.5	3.9	7.8	5.0	B	S1	IP44	177	
75/0.10	3000	180	24	12	0.5	3.9	7.8	2.5	B	S1	IP44	177	

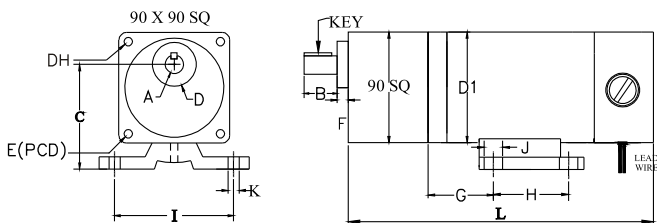
**DYNAFLUX D75 SERIES INLINE GEARED P. M. DC MOTORS**
**FOOT CUM FLANGE MOUNTING**

MECHANICAL DIMENSIONS FOR INLINE FLANGE GEARED MOTORS.

D1	A	B	C	D	F	E	DH	G	H	I	J	K	L	KEY
75	15	28	77	36	10	104	8	38	30	60	8	8	243	25X5X5

SPECIFICATIONS

POWER IN WATTS/HP	SPEED IN RPM	VOLTS. IN DC			CURR. IN AMPS			RATIO			O/P SPEED IN RPM			TORQUE IN KG-CM	INSL. CLASS	DUTY CYCLE	PROTE-ENCL. CTION	WEIGHT (KG)			
		V1	V2	V3	A1	A2	A3	R1	R2	R3	S1	S2	S3						T1	T2	T3
40/0.05	1500	180			0.3			5	10	30	300	150	50	4	8	20	B	S1	IP44	TENV	5.0
75/0.10	1500	180	24	12	0.5	3.9	7.8	5	10	30	300	150	50	8	16	40	B	S1	IP44	TENV	

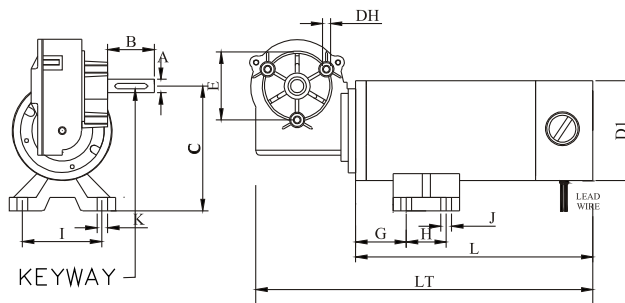
**DYNAFLUX D75 SERIES WORM GEARED P. M. DC MOTORS**

MECHANICAL DIMENSIONS FOR WORM FOOT/FLANGE GEARED MOTORS.

A	B	C	E	G	H	I	J	K	D1	DH	L	LT	KEYWAY
10	35	94	51	38	30	60	8	8	75	M6	178	253	25X4X2D

SPECIFICATIONS

POWER IN WATTS/HP	SPEED IN RPM	VOLTAGE IN DC			CURR. IN AMPS			RATIO			O/P SPEED IN RPM			TORQUE IN KG-CM	ENCL.	INSL CLASS	DUTY CYCLE	PROTEC	WEIGHT (KG)		
		V1	V2	V3	A1	A2	A3	R1	R2	R3	S1	S2	S3							T1	T2
40/0.05	2000	180			0.3			55	27.5	18	35	70	110	40	20	10	TENV	B	S1	IP44	4.8
75/0.10	2000	180	24	12	0.5	3.9	7.8	55	27.5	18	35	70	110	80	40	20	TENV	B	S1	IP44	

NOTE- THE ABOVE DIMENSION ARE FLANGE CUM FOOT MOUNTED.  
NORMAL MOUNTING IS FLANGE MOUNTED.