

MODEL	ELECTRICAL SPECIFICATIONS.											MECHANICAL SPECIFICATIONS.											
	OUTPUT		VOLTAGE	FREQUENCY	INPUT	CURRENT	TORQUE	SPEED	CAPACITOR	DUTY CYCLE	INSULATION CLASS	ENCL.	A x A Sq	A	B	C	D	E	F	ØM	ØS	L	LT
	HP	W	V	Hz	W	A	Kg-cm	rpm	µF														
AC INDUCTION SINGLE PHASE MOTOR																							
MM8IN25SC4	1/30	25	1 φ 220-240 VAC	50	60	0,25	1,95	1300	1,5	S1	B	TENV	80 X 80	8	7	32	2	73	25	5,5	94	92	-
MM9IN40SC4	1/18,5	40	1 φ 220-240 VAC	50	85	0,4	3	1300	2,5	S1	B	TENV	90 X 90	10	9	37	2	83	25	6,5	104	110	-
MM9IF60SC4	1/12,5	60	1 φ 220-240 VAC	50	130	0,6	4,5	1300	4,0	S1	B	TEFC	90 X 90	12	11	37	2	83	25	6,5	104	-	130
MM9IF90SC4	1/8	90	1 φ 220-240 VAC	50	200	0,9	6,8	1300	6,0	S1	B	TEFC	90 X 90	12	11	37	2	83	25	6,5	104	-	145
MM9IF120SC4	1/6	120	1 φ 220-240 VAC	50	260	1,0	9	1300	7,0	S1	B	TEFC	90 X 90	12	11	37	2	83	25	6,5	104	-	145
MM9IF180SC4	1/4	180	1 φ 220-240 VAC	50	330	1,3	13,5	1300	6,5	S1	B	TEFC	90 X 90	12	11	37	2	83	25	6,5	104	-	165
AC INDUCTION REVERSIBLE MOTOR																							
MM8RN25SC4	1/30	25	1 φ 220-240 VAC	50	60	0,3	1,95	1300	2,0	S2	B	TENV	80 X 80	8	7	32	2	73	25	5,5	94	92	-
MM9RN40SC4	1/18,5	40	1 φ 220-240 VAC	50	85	0,5	3	1300	3,5	S2	B	TENV	90 X 90	10	9	37	2	83	25	6,5	104	110	-
MM9RF60SC4	1/12,5	60	1 φ 220-240 VAC	50	130	0,7	4,5	1300	5,0	S2	B	TEFC	90 X 90	12	11	37	2	83	25	6,5	104	-	130
MM9RF120SC4	1/6	120	1 φ 220-240 VAC	50	260	1,1	9,4	1300	9,0	S2	B	TEFC	90 X 90	12	11	37	2	83	25	6,5	104	-	145
AC INDUCTION THREE PHASE MOTOR																							
MM8IN25SK4	1/30	25	3 φ 220 VAC	50	60	0,3	1,95	1300	-	S1	B	TENV	80 X 80	8	7	32	2	73	25	5,5	94	92	-
MM9IN40SK4	1/18,5	40	3 φ 220 VAC	50	85	0,4	3	1300	-	S1	B	TENV	90 X 90	10	9	37	2	83	25	6,5	104	110	-
MM9IF60PK4	1/12,5	60	3 φ 220 VAC	50	130	0,5	4,5	1300	-	S1	B	TEFC	90 X 90	12	11	37	2	83	25	6,5	104	-	130
MM9IF120PK4	1/6	120	3 φ 220 VAC	50	260	0,8	9	1300	-	S1	B	TEFC	90 X 90	12	11	37	2	83	25	6,5	104	-	145
MM9IF200PK4	1/4	180	3 φ 220 VAC	50	330	1,2	15	1300	-	S1	B	TEFC	90 X 90	12	11	37	2	83	25	6,5	104	-	165

## AC INDUCTION INLINE GEARED MOTORS

**25 watts Motor Frame size 80 mm sq.**

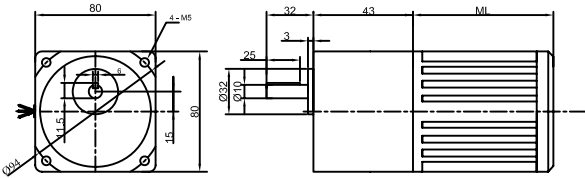

**40-200 watts Motor Frame size 90 mm sq.**

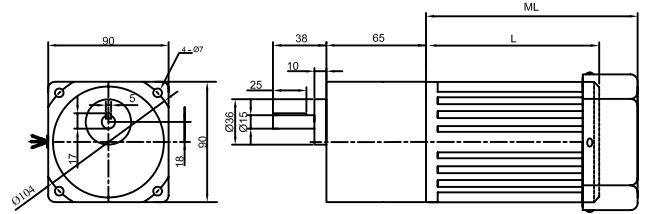

RATED TORQUE OF INLINE GEAR HEAD														
Application	MODEL	RATIO	O / P SYN	TORQUE Kg-cm						25 & 40	60 Watts	90 & 120	180 & 200	
				40 W	60 W	90 W	120 W	180 W	200 W	Watts L	ML	Watts ML	Watts ML	
25 Watts MOTOR	MMC8G7.5	7.5	175	12	-	-	-	-	-	92	-	-	-	
	MMC8G12.5	12.5	105	19	-	-	-	-	-	92	-	-	-	
	MMC8G15	15	85	23	-	-	-	-	-	92	-	-	-	
	MMC8G30	30	45	42	-	-	-	-	-	92	-	-	-	
	MMC8G50	50	25	64	-	-	-	-	-	92	-	-	-	
	MMC8G100	100	13	80	-	-	-	-	-	92	-	-	-	
40, 60, 90, 120, 180 Watts MOTOR	MMC9P10	10	130	18	27	41	57	82	91	110	130	145	165	
	MMC9P15	15	85	36	54	74	102	147	164	110	130	145	165	
	MMC9P30	30	45	65	98	134	186	267	297	110	130	145	165	
	MMC9P50	50	25	90	100	200	200	300	300	110	130	145	165	
	MMC9P100	100	13	100	100	200	200	300	300	110	130	145	165	
	MMC9P180	180	7	100	100	200	200	300	300	110	130	145	165	
					40 W	60 W	90 W	120 W	180 W	200 W	40 W	60 W	60 & 90 W	180 & 200 W

## AC INDUCTION WORM GEARED MOTORS

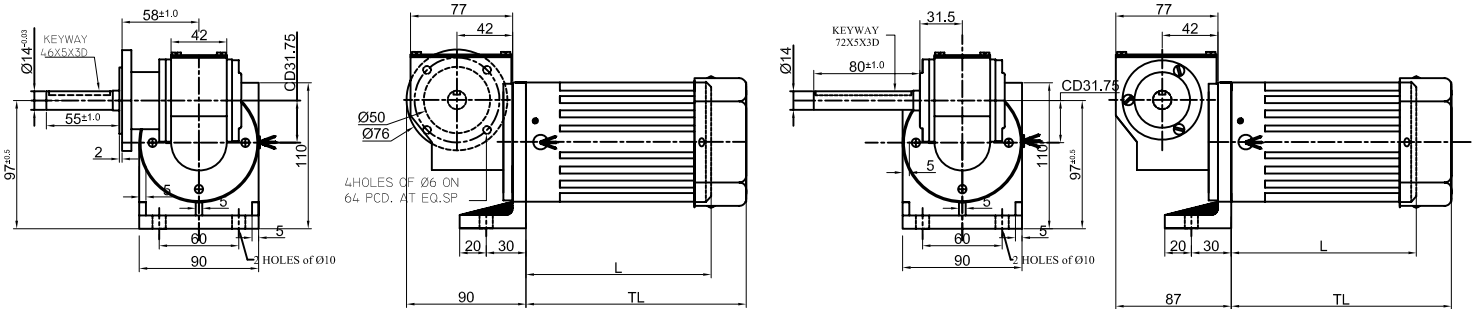

RATED TORQUE OF WORM GEAR HEAD													
Application	MODEL	RATIO	O / P SYN	TORQUE Kg-cm						40 Watts	60 Watts	90 & 120	180 & 200
				40 W	60 W	90 W	120 W	180 W	200 W	L	ML	Watts ML	Watts ML
40, 60, 90, 120, 180 Watts MOTOR	WORM FOOT			40 W	60 W	90 W	120 W	180 W	200 W				
	MMC9W10	10	125	10	20	30	40	50	60	110	130	145	165
	MMC9W16	16	75	20	40	60	80	100	120	110	130	145	165
	MMC9W24	24	50	30	60	70	100	120	150	110	130	145	165
40, 60, 90, 120, 180 Watts MOTOR	MMC9W48	48	25	40	80	100	120	180	200	110	130	145	165
	WORM FLANGE			40 W	60 W	90 W	120 W	180 W	200 W				
	MMC9W10F	10	125	10	20	30	40	50	60	110	130	145	165
	MMC9W16F	16	75	20	40	60	80	100	120	110	130	145	165
	MMC9W24F	24	50	30	60	70	100	120	150	110	130	145	165
	MMC9W48F	48	25	40	80	100	120	180	200	110	130	145	165

\* All dimension are in mm

\* We fully reserve the right to change the design or specification without prior notice