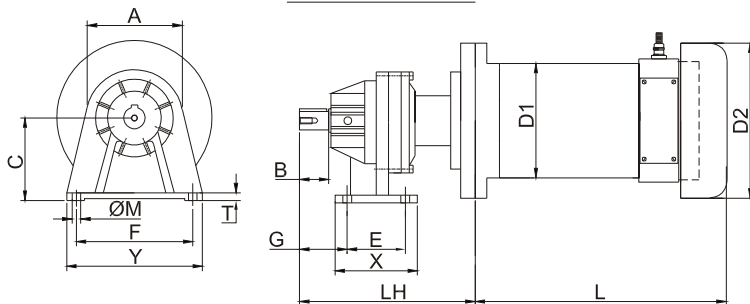
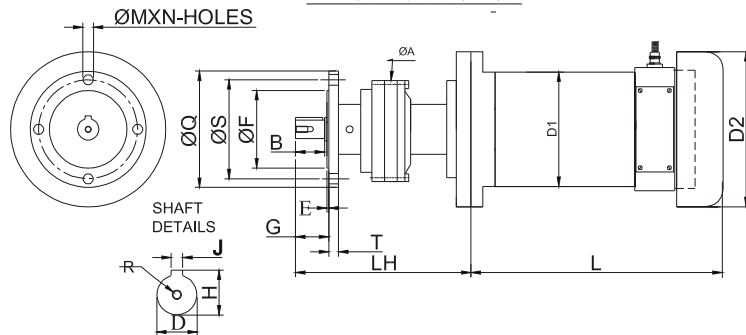

DYNAFLUX D 127 & 142 BATTERY OPERATED PLANETARY GEARED P. M. DC MOTORS

FOOT MOUNTING

FLANGE MOUNTING

MODEL			OUTPUT SHAFT						FOOT MOUNTING									OVERALL		
SINGLE STAGE	DOUBLE STAGE	TRIPPLE STAGE	Dj6	H	Jp9	R	B	A	C	X	Y	E	F	T	G	M	LH	LH	LH	
1019	2019	3019	19	21.5	6	M6	30	100	85	85	140	60	120	8	49	9	181	210	240	
1028	2028	3028	28	31	8	M8	42	130	102	110	170	80	140	12	62	14	227	244	273	
-	2029	3029	28	31	8	M8	42	130	102	110	170	80	140	12	62	14	-	268	308	
1038	2038	3038	38	41	10	M10	30	162	105	120	180	90	140	12	85	14	280	313	329	
-	2039	3039	38	41	10	M10	30	162	105	120	180	90	140	12	85	14	-	332	353	
1050	2050	3050	50	53.5	14	M12	75	195	125	150	215	115	180	15	105	14	356	381	413	
1060	2060	3060	60	64	18	M12	90	240	150	180	260	140	210	16	125	18	434	459	484	
1070	2070	3070	70	74.5	20	M16	100	280	165	205	300	150	250	18	140	18	462	494	519	

MODEL			FLANGE MOUNTING											OVERALL		
SINGLE STAGE	DOUBLE STAGE	TRIPPLE STAGE	A	Q	S	Fh8	E	T	G	N	M	LH	LH	LH		
1019	2019	3019	100	120	102	80	2	10	34	4	11	181	210	240		
1028	2028	3028	130	135	115	95	3	10	47	4	11	227	244	273		
-	2029	3029	130	135	115	95	3	10	47	4	11	-	268	308		
1038	2038	3038	162	155	135	100	5	13	65	8	9	280	313	329		
-	2039	3039	162	155	135	100	5	13	65	8	9	-	332	353		
1050	2050	3050	195	200	165	130	10	12	90	8	14	356	381	413		
1060	2060	3060	240	220	190	160	10	16	105	8	14	434	459	484		
1070	2070	3070	280	240	200	160	12	16	120	8	14	462	494	519		

SPECIFICATIONS																			
POWER IN WATTS/HP	SPEED IN RPM	VOLTAGE IN VDC		CURRENT IN AMPS.		GB. MODEL	RATIO		O/P SPEED IN RPM		TORQUE IN KG-CM		INSL. CLASS	DUTY CYCLE	PROTEC-TION	D1	D2	L	WEIGHT (KG)
		V1	V2	A1	A2		R1	R2	S1	S2	T1	T2							
746/1.0	1500	24	48	39.0	19.4	3028	48	-	30	-	2000	-	B	S1	IP44	127	160	320	38.0
746/1.0	1500	24	48	39.0	19.4	2028	19.2	-	75	-	800	-	B	S1	IP44	127	160	320	30.0
746/1.0	1500	24	48	39.0	19.4	1019	5.2	3.60	250	400	300	200	B	S1	IP44	127	160	320	30.0
1120/1.5	1500	-	48	-	29.1	3038	46.5	-	30	-	3000	-	B	S1	IP44	127	160	368	38.0
1120/1.5	1500	-	48	-	29.1	2028	19.2	-	75	-	1200	-	B	S1	IP44	127	160	368	30.0
1120/1.5	1500	-	48	-	29.1	1028	4.6	3.60	300	400	350	250	B	S1	IP44	127	160	368	30.0
1490/2.0	1500	-	48	-	39.0	3039	46.45	-	30	-	4000	-	B	S1	IP44	142	160	368	35.0
1490/2.0	1500	-	48	-	39.0	2029	16.68	-	75	-	1500	-	B	S1	IP44	142	160	368	34.0
1490/2.0	1500	-	48	-	39.0	1028	4.60	3.65	300	400	500	350	B	S1	IP44	142	160	368	32.0