

## DYNAFLUX D 118 INDUSTRIAL GRADE PLANETARY GEARED P. M. DC MOTORS

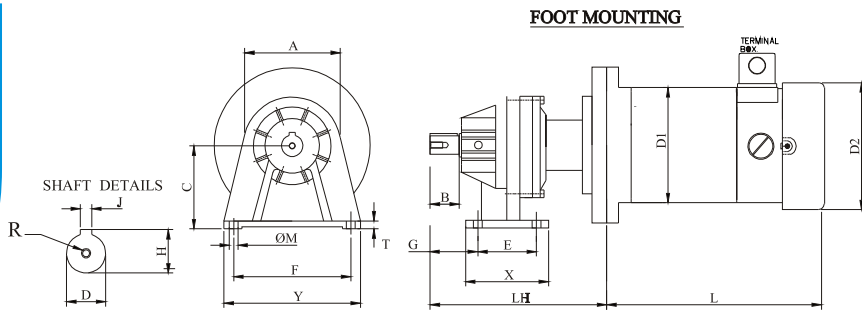
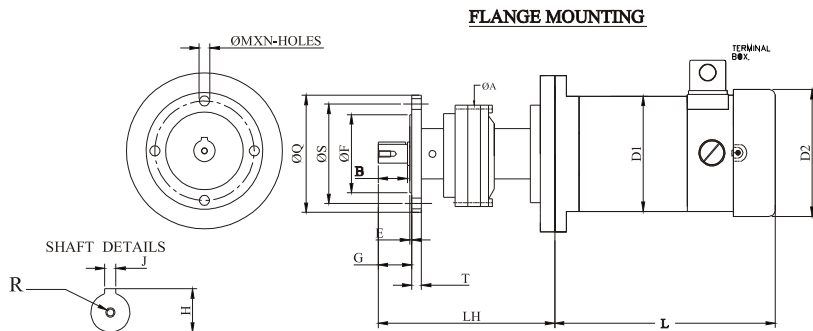

MODEL			OUTPUT SHAFT					FOOT MOUNTING										OVERALL		
SINGLE STAGE	DOUBLE STAGE	TRIPPLE STAGE	Dj6	H	Jp9	R	B	A	C	X	Y	E	F	T	G	M	LH	LH	LH	
1019	2019	3019	19	21.5	6	M6	30	100	85	85	140	60	120	8	49	9	181	210	240	
1028	2028	3028	28	31	8	M8	42	130	102	110	170	80	140	12	62	14	227	244	273	
-	2029	3029	28	31	8	M8	42	130	102	110	170	80	140	12	62	14	-	268	308	
1038	2038	3038	38	41	10	M10	30	162	105	120	180	90	140	12	85	14	280	313	329	
-	2039	3039	38	41	10	M10	30	162	105	120	180	90	140	12	85	14	-	332	353	
1050	2050	3050	50	53.5	14	M12	75	195	125	150	215	115	180	15	105	14	356	381	413	
1060	2060	3060	60	64	18	M12	90	240	150	180	260	140	210	16	125	18	434	459	484	
1070	2070	3070	70	74.5	20	M16	100	280	165	205	300	150	250	18	140	18	462	494	519	

MODEL			FLANGE MOUNTING										OVERALL		
SINGLE STAGE	DOUBLE STAGE	TRIPPLE STAGE	A	Q	S	Fh8	E	T	G	N	M	LH	LH	LH	
1019	2019	3019	100	120	102	80	2	10	34	4	11	181	210	240	
1028	2028	3028	130	135	115	95	3	10	47	4	11	227	244	273	
-	2029	3029	130	135	115	95	3	10	47	4	11	-	268	308	
1038	2038	3038	162	155	135	100	5	13	65	8	9	280	313	329	
-	2039	3039	162	155	135	100	5	13	65	8	9	-	332	353	
1050	2050	3050	195	200	165	130	10	12	90	8	14	356	381	413	
1060	2060	3060	240	220	190	160	10	16	105	8	14	434	459	484	
1070	2070	3070	280	240	200	160	12	16	120	8	14	462	494	519	

SPECIFICATIONS																
POWER IN WATTS/HP	SPEED IN RPM	VOLTAGE IN VDC	CURR. IN AMPS	GB. MODEL	RATIO	O/P SPEED IN RPM	TORQUE IN KG-CM	INSL. CLASS	DUTY CYCLE	PROTEC-TION	ENCL.	D1	D2	L	WEIGHT (KG)	
360/0.5	1500	180	2.6	3028	47.5	30	1000	B	S1	IP44	TEFC	118	130	259	22.0	
360/0.5	1500	180	2.6	2019	19.2	75	450	B	S1	IP44	TEFC	118	130	259	22.0	
360/0.5	1500	180	2.6	1019	5.7	250	150	B	S1	IP44	TEFC.	118	130	259	20.0	
360/0.5	1500	180	2.6	1019	3.60	400	100	B	S1	IP44	TEFC	118	130	259	20.0	
560/0.75	1500	180	3.8	3028	47.5	30	1500	B	S1	IP44	TEFC	118	130	280	24.0	
560/0.75	1500	180	3.8	2019	19.2	75	600	B	S1	IP44	TEFC	118	130	280	24.0	
560/0.75	1500	180	3.8	1019	5.7	250	200	B	S1	IP44	TEFC	118	130	280	22.0	
560/0.75	1500	180	3.8	1019	3.60	400	150	B	S1	IP44	TEFC	118	130	280	22.0	